

Parts List												
ITEM	PART ID	DRAWING #	PART NAME	DESCRIPTION	VISUAL	UM	TOTAL LBS	QTY	LNG EA			
1	5049567	NA	ELBOW	ELBOW 0.500 NPT 6000# 90 SA182-347H	0	EA	1.3	2	0'-0"			
2	5000611	NA	FLAT WASHER	WASHER FLAT 0.375 USS F844 ZINC	0	EA	0.0	4	0'-0"			
3	5018507	NA	FOOT MOUNT KIT	FOOT MOUNT KIT CMFK #62490	0	EA	0.2	8	0'-0"			
4	5049559	NA	GASKET	GASKET 1.500 1500# RTJ 347H	0	EA	1.6	6	0'-0"			
5	5049338	NA	GASKET	GASKET 4.000 1500# RTJ 347H	0	EA	6.7	8	0'-0"			
6	5049558	NA	GASKET	GASKET 8.000 1500# RTJ 347H	0	EA	10.8	3	0'-0"			
7	NA	18136-HA	HEATER ASSEMBLY	SEE DETAIL DRAWING	0	EA	56035.2	1	0'-0"			
8	NA	18136-HD2	HEATER DUCT 2	SEE DETAIL DRAWING	0	EA	33.5	1	0'-0"			
9	NA	18136-HD3	HEATER DUCT 3	SEE DETAIL DRAWING	0	EA	66.7	1	0'-0"			
10	NA	18136-HD4	HEATER DUCT 4	SEE DETAIL DRAWING	0	EA	74.2	1	0'-0"			
11	NA	18136-FTNG	HEATER GA.	SEE DETAIL DRAWING	0	EA	1560.8	1	0'-0"			
12	NA	18136-HIH	HEATER INLET HEADER	SEE DETAIL DRAWING	0	EA	1490.3	1	0'-0"			
13	NA	18136-HOH	HEATER OUTLET HEADER	SEE DETAIL DRAWING	0	EA	1527.2	1	0'-0"			
14	NA	18136-HSTB	HEATER STACK BOTTOM ASSEMBLY	SEE DETAIL DRAWING	0	EA	1271.7	1	0'-0"			
15	NA	18136-HSTE	HEATER STACK ELBOW	SEE DETAIL DRAWING	0	EA	333.1	1	0'-0"			
16	NA	18136-HSTM	HEATER STACK MIDDLE ASSEMBLY	SEE DETAIL DRAWING	0	EA	1253.0	1	0'-0"			
17	NA	18136-HSTT	HEATER STACK TOP ASSEMBLY	SEE DETAIL DRAWING	0	EA	1139.2	1	0'-0"			
18	5000631	NA	HEX BOLT	BOLT HEX 0.375-16x1.500 J429-G5 ZINC	0	EA	0.5	8	0'-0"			
19	5000640	NA	HEX BOLT	BOLT HEX 0.500-13x1.250 J429-G5 ZINC	0	EA	2.3	20	0'-0"			
20	5000623	NA	HEX BOLT	BOLT HEX 0.500-13x1.500 J429-G5 ZINC	0	EA	10.5	80	0'-0"			
21	5020889	NA	HEX BOLT	BOLT HEX 0.875-9x2.000 J429-G5 ZINC	0	EA	2.3	4	0'-0"			
22	5049563	NA	HEX NUT	NUT 1.250-8 A194 8C	0	EA	110.8	128	0'-0"			
23	5049565	NA	HEX NUT	NUT 1.000-8 A194 8C	0	EA	22.6	48	0'-0"			
24	5049564	NA	HEX NUT	NUT 1.625-8 A194 8C	0	EA	87.0	48	0'-0"			
25	5013471	NA	HEX NUT	NUT HEX 0.250-20 J995-G5 ZINC	0	EA	0.0	2	0'-0"			
26	5000607	NA	HEX NUT	NUT HEX 0.375-16 J995-G5 ZINC	0	EA	0.4	24	0'-0"			
27	5024517	NA	HEX NUT	NUT HEX 0.500-13 J995-G5 ZINC	0	EA	5.0	116	0'-0"			
28	5043765	NA	HEX NUT	NUT HEX 0.875- 9 J995-G5 ZINC	0	EA	1.3	4	0'-0"			
29	5006864	NA	HEX NUT	NUT HEX 0.875-9 SA194-2H CAD	0	EA	3.2	10	0'-0"			
30	5049568	NA	NIPPLE	NIPPLE 0.500 NPT X 2.000 S160 SA312-TP347H	0	EA	1.1	5	0'-2"			
31	NA	18136-OPS1	OUTLET PIPE SPOOL 1	SEE DETAIL DRAWING	0	EA	1772.3	1	0'-0"			
32	NA	18136-OPS2	OUTLET PIPE SPOOL 2	SEE DETAIL DRAWING	0	EA	980.1	1	0'-0"			
33	5049537	NA	PIPE SUPPORT	PIPE SUPPORT GUIDE FIG 801 8"	0	EA	28.6	2	0'-0"			
34	5021173	NA	STUD	STUD 0.875-9X 5.750 SA193 B7 CAD	0	EA	4.9	5	0'-0"			
35	5049562	NA	STUD	STUD 1.000-8X5.500 A193 B8C	0	EA	29.4	24	0'-0"			
36	5049560	NA	STUD	STUD 1.250-8X7.750 A193 B8C	0	EA	172.8	64	0'-7 3/4"			
37	5049561	NA	STUD	STUD 1.625-8X11.500 A193 B8C	0	EA	162.4	24	0'-0"			
38	5006592	NA	U-BOLT	U-BOLT 2.000 PIPEX0.375-16 SA307A STD ZINC	0	EA	0.5	2	0'-0"			
39	5013058	NA	U-BOLT	U-BOLT 8.000 PIPEX0.500-13 A307A STD ZINC	0	EA	11.8	8	0'-0"			
40	5011067	NA	U-BOLT	U-BOLT 0.750 PIPEX0.250-20 A307A STD ZINC	0	EA	0.1	1	0'-0"			
41	5000643	NA	U-BOLT	U-BOLT 2.500 PIPEX0.375-16 A307A STD ZINC	0	EA	0.6	2	0'-0"			
42	5000012	NA	FUEL TRAIN PIPE SUPPORT 1	PLATE STEEL 0.375" A36 HR	0	LBS	13.8	3	0'-0"			
43	5000012	NA	FUEL TRAIN PIPE SUPPORT 2	PLATE STEEL 0.375" A36 HR	0	LBS	6.3	1	0'-0"			

REVISION HISTORY			
REV	DESCRIPTION	DATE	APPROVED
3	ADDED SHEET TWO GAS TRAIN SUPPORTS	12/19/2014	MRP
2	ADDED VALVES TO INLET AND OUTLET SPOOLS	12/14/2018	MRP
1	REMOVED 1.000 INCH HEX NUT	11/20/2018	MRP
CUSTOMER: ENCORE DEC		JOB#: HI 18-136	
DRAWING NAME: HEATER GENERAL ASSEMBLY		WID#: 18-136-151-000	
VHC1 16010-40-Q-G		ISSUE DATE: 12/17/18	
HEATEC INC. an Astec company		P.O. BOX 72760 CHATTANOOGA, TN 37407 PHONE: (423) 821-5200 FAX: (423) 821-7673	
DWG. DATE: 9/27/18-MRP	CHK. DATE: MGN 12/19/2018	APPR. DATE:	
DWG. PART#: 18136-HGA	REV: 3	SCALE: 1/50	WEIGHT: 88717 lbm
TOLERANCE IS +/- 1/4" UNLESS OTHERWISE NOTED. THIS DRAWING AND THE DESIGN SHOWN THEREIN IS THE PROPERTY OF HEATEC INC. AND THE USE OR COPIES THEREOF CANNOT BE MADE WITHOUT WRITTEN CONSENT.			

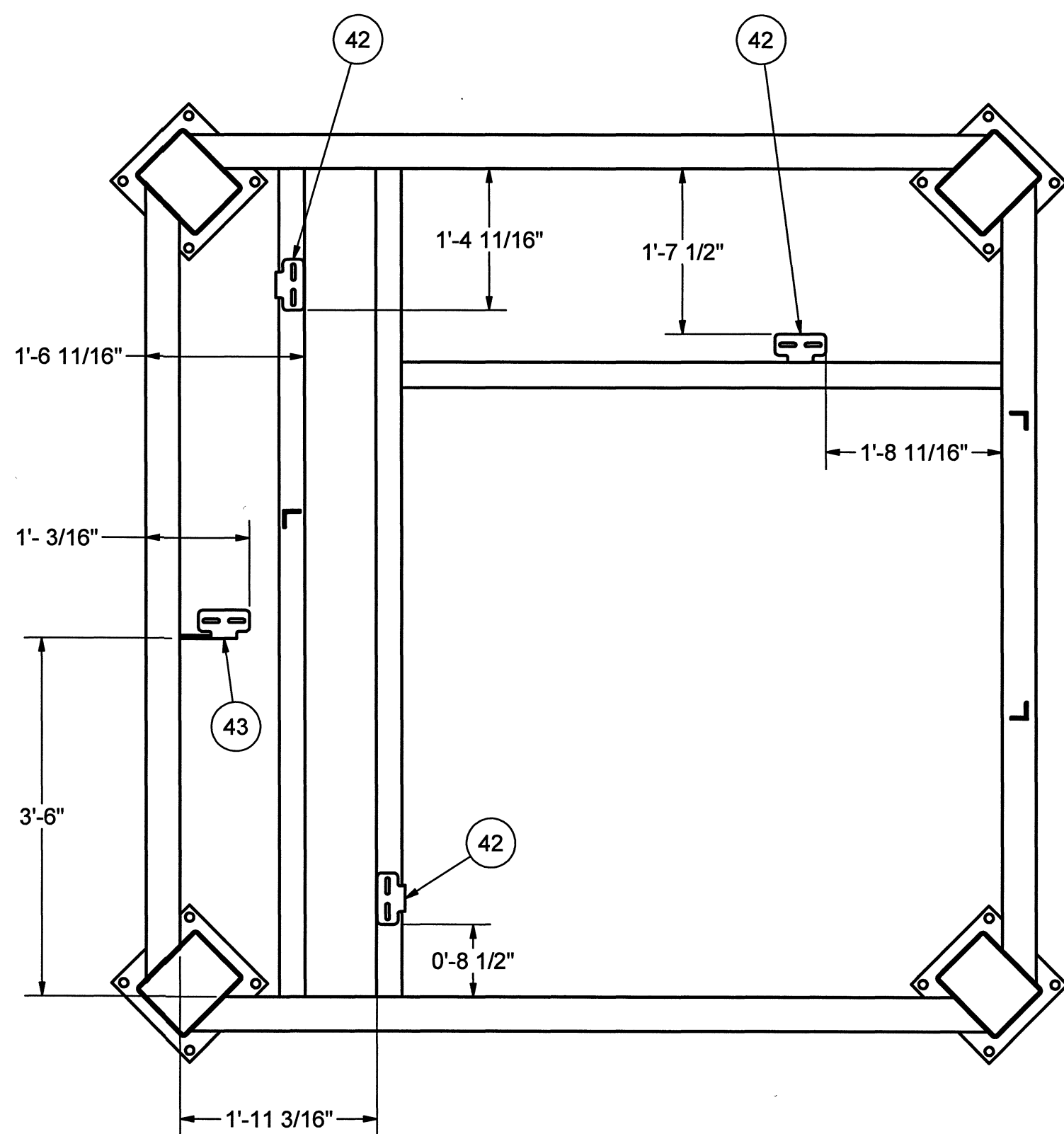

GAS TRAIN SUPPORTS  
SCALE 1 / 16

CUSTOMER: ENCORE DEC		JOB#: HI 18-136	
DRAWING NAME: HEATER GENERAL ASSEMBLY VHCI 16010-40-Q-G		WORK: 18-136-151-000	
		ISSUE DATE: 12/13/18 <i>ms</i>	
<b>HEATEC INC.</b> <i>an Asso company</i>		P.O. BOX 72760 CHATTANOOGA, TN 37407 PHONE: (423) 821-5200 FAX: (423) 821-7673	
DWG. DATE: 9/27/18-MRP	CHK. DATE: <i>McW 12/14/2018</i>	APPR. DATE:	
DWG. PART: 18136-HGA	REV.:	SCALE:	WEIGHT: 88717
TOLERANCE IS +/- 1/4" UNLESS OTHERWISE NOTED.		THIS DRAWING AND THE DESIGN SHOWN THEREIN IS THE PROPERTY OF HEATEC INC. AND THE USE OR COPIES THEREOF CANNOT BE MADE WITHOUT WRITTEN CONSENT.	